

Drawing & Dimension

Passenger Elevator Manual Door

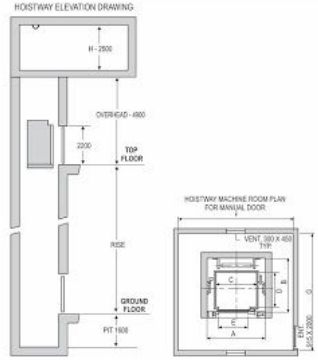

HOISTWAY MACHINE ROOM SIZE
PASSENGER LIFT WITH MANUALLY OPERATED DOORS

LOAD	LIFT WELL		CAR INSIDE		ENTRANCE		MACHINE ROOM		
	PERSON	WEIGHT	WIDTH	DEPTH	WIDTH	DEPTH	WIDTH	DEPTH	HEIGHT
	IN KG.	A	B	C	D	E	F	G	H
4	272	1600	1250	1100	700	3000	3000	2500	
5	340	1600	1300	1100	850	750	3000	3200	2500
6	408	1670	1370	1100	1000	750	3000	3500	2500
8	544	1900	1600	1300	1100	750	3200	3500	2500
10	680	1950	1800	1350	1300	1000	3500	4000	2500
13	884	2500	1600	2000	1100	1000	4000	4200	2500
16	1088	2500	1800	2000	1300	1000	4500	4800	2500
20	1360	2500	2050	2000	1550	1000	5000	5000	2500

All Dimension are in mm. This is General Data, it may be changed without notice. All hoistway walls should be minimum 230 mm brick or 150 mm R. C. C.

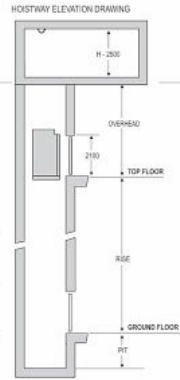

Passenger Elevator Auto Doors

HOISTWAY MACHINE ROOM SIZE PASSENGER LIFT WITH AUTO DOORS

LOAD	LIFT WELL		CAR INSIDE		ENTRANCE		MACHINE ROOM			UP TO 1.5 M/Sec.		UP TO 2.5 M/Sec.	
	PERSON	WEIGHT	WIDTH	DEPTH	WIDTH	DEPTH	WIDTH	DEPTH	HEIGHT	PIT	O.H.	PIT	O.H.
	IN KG.	A	B	C	D	E	F	G	H	K	M	K	M
6	408	1900	1650	1100	1000	800	3000	3500	2500	1600	4800	2600	6700
8	544	1900	1900	1300	1100	800	3200	3500	2500	1600	4800	2800	6700
10	680	1900	2000	1350	1300	800	3500	4000	2500	1600	4800	2600	6700
13	884	2500	1900	2000	1100	1000	4000	4200	2500	1600	4800	2600	6700
16	1088	2500	2200	2000	1300	1000	4500	4800	2500	1600	4800	2600	6700
20	1360	2500	2300	2000	1550	1000	5000	5000	2500	1600	4800	2600	6700

All Dimension are in mm. This is General Data, it may be changed without notice. All hoistway walls should be minimum 230 mm brick or 150 mm R. C. C.

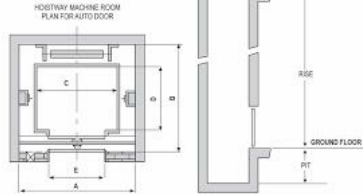

MRL Elevator

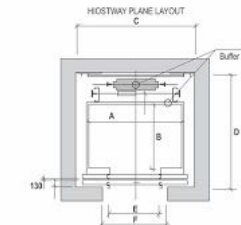
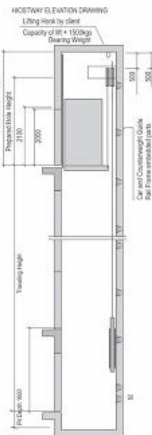

HOISTWAY MACHINE ROOM SIZES

Person	Capacity	Lift Well		Car Inside		Clear Entrance	Clear Opening at landing	
		C	D	A	B		F	F
6	408	1800	1400	1200	900	700	780 / 2100	1450 / 2350
8	544	1900	1600	1300	1100	800	880 / 2100	1600 / 2350
10	680	1900	1800	1300	1300	800	880 / 2100	1600 / 2350
13	884	2200	1900	1600	1400	900	980 / 2100	1700 / 2350

All Dimensions are in mm size.

Home Elevator

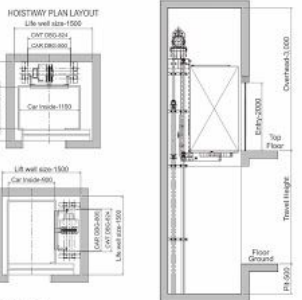

SPECIFICATION

Frequency	120 RPM	Pulley Dia	100 mm
Voltage	220 VAC	Rope Dia	4 mm
KW / Hp	0.75 / 1	No. of Ropes	4
Weight	70 kg	Lifting Capacity	300 kg
Brake	Pick-up : 220 VDC Holding : 110 VDC	Lift Speed	0.2 m/s
		Max. Travel	15 Ms
		Starts / Day	100

All Dimension are in mm. This is General Data, it may be changed without notice.

Capsule Elevator

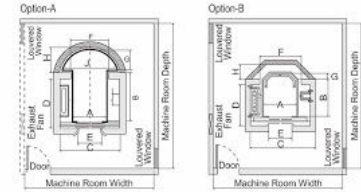

Option - A

Load	Car Inside					Lift Well			Entrance		
	Person	Kgs.	A	B	J	G	C	D	F	H	E
10	680	1100	1300	1400	950	2200	1425	1330	1100	800	
13	884	1200	1400	1550	700	2400	1525	1430	1100	900	
16	1088	1300	1500	1700	750	2600	1625	1530	1200	1000	

Option - B

Load	Car Inside					Lift Well			Entrance	
	Person	Kgs.	A	B	G	C	D	F	H	E
10	680	1250	1300	250	2200	1450	1480	580	800	
13	884	1400	1400	300	2400	1550	1630	650	900	
16	1088	1550	1500	350	2800	1780	1650	790	1000	

Hydraulic Elevator

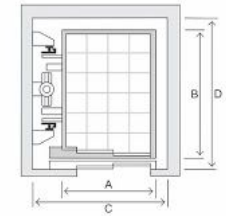

ROPE TYPE 1
It is a single side indirectly acting suspension with wire ropes having one piston for regular loads and long travels of maximum 12 meters.

Persons	Capacity Kg	Car-w (A)	Card-d (B)	Shaft-w (C)	Shaft-d (D)
3	225	800	900	1300	1300
4	300	850	1050	1350	1450
5	375	1000	1200	1500	1500
6	450	1100	1250	1600	1600
8	600	1200	1500	1750	1800
10	750	1200	1700	1750	2200
12	900	1300	1800	1850	2100
15	1125	1300	2200	1850	2500
20	1600	1400	2500	1950	2800

Hospital Elevator

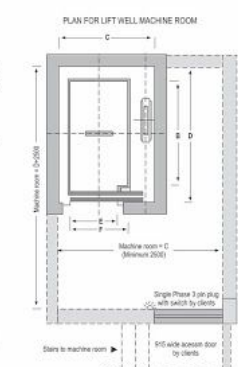
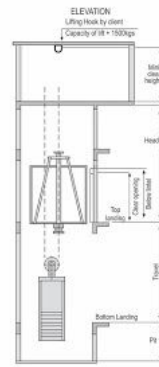

DIMENSIONAL DETAILS : HOSPITAL LIFT

Type	Capacity	Car Inside		Lift Well		Clear Entrance	Clear Opening at Landing	O.H.	Pit	Speed
		A	B	C	D					
Wheel Chair	544 kg	1100	1300	1700	1850	800	920 x 2150	4200	1600	.63 mps
Stretcher	750 kg	1000	2100	1700	2500	800	920 x 2150	4400	1600	.33 mps
Small Bed	1020 kg	1200	2100	1900	2500	900	1120 x 2150	4400	1600	.35 mps
Standard Bed	1360 kg	1600	2400	2500	2800	1200	1420 x 2150	4400	1600	.35 mps

All Dimensions are in mm size.

Goods Elevator

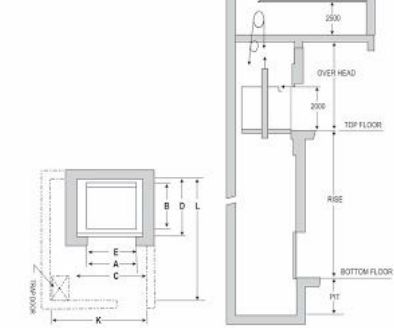

HOISTWAY MACHINE ROOM SIZES

LOAD IN KG.	Car Inside		Lift Well		Clear Opening	Wall Opening		Machine Room		Pit Depth	Over Head	Speed
	A	B	C	D		F	G	H	Height			
500	1200	1200	1650	1650	800 X 2000	1150 X 2225	2700	2700	2500	1600	4200	0.35
1000	1700	1600	2400	1900	1200 X 2000	1625 X 2225	3500	3000	2500	1600	4800	0.35
1500	2000	2000	2700	2300	1500 X 2000	2000 X 2225	4000	4000	2500	1600	4600	0.35
2000	2200	2500	2900	2800	1500 X 2000	2000 X 2225	4000	4200	2500	1600	4600	0.35
2500	2500	2500	3200	2800	1600 X 2000	2100 X 2225	4500	4500	2500	1600	4800	0.35
3000	2500	3200	3300	3500	1600 X 2000	2100 X 2225	4500	5200	2500	1600	5200	0.35
4000	2500	4000	3400	4000	2000 X 2000	2600 X 2225	4500	6300	2500	1600	5200	0.35